

# Parts List H.30<sup>®</sup> Handpiece

H.30<sup>®</sup> Handpieces manufactured before July, 1997 have different spindle and bearing assemblies and a different groove pattern on the outside of the main housing (see photos below). Items 5, 6, 7, and 8 listed below cannot be used on these older handpieces. Contact Foredom Customer Service if your handpiece is the older version and you need parts that are not listed here.

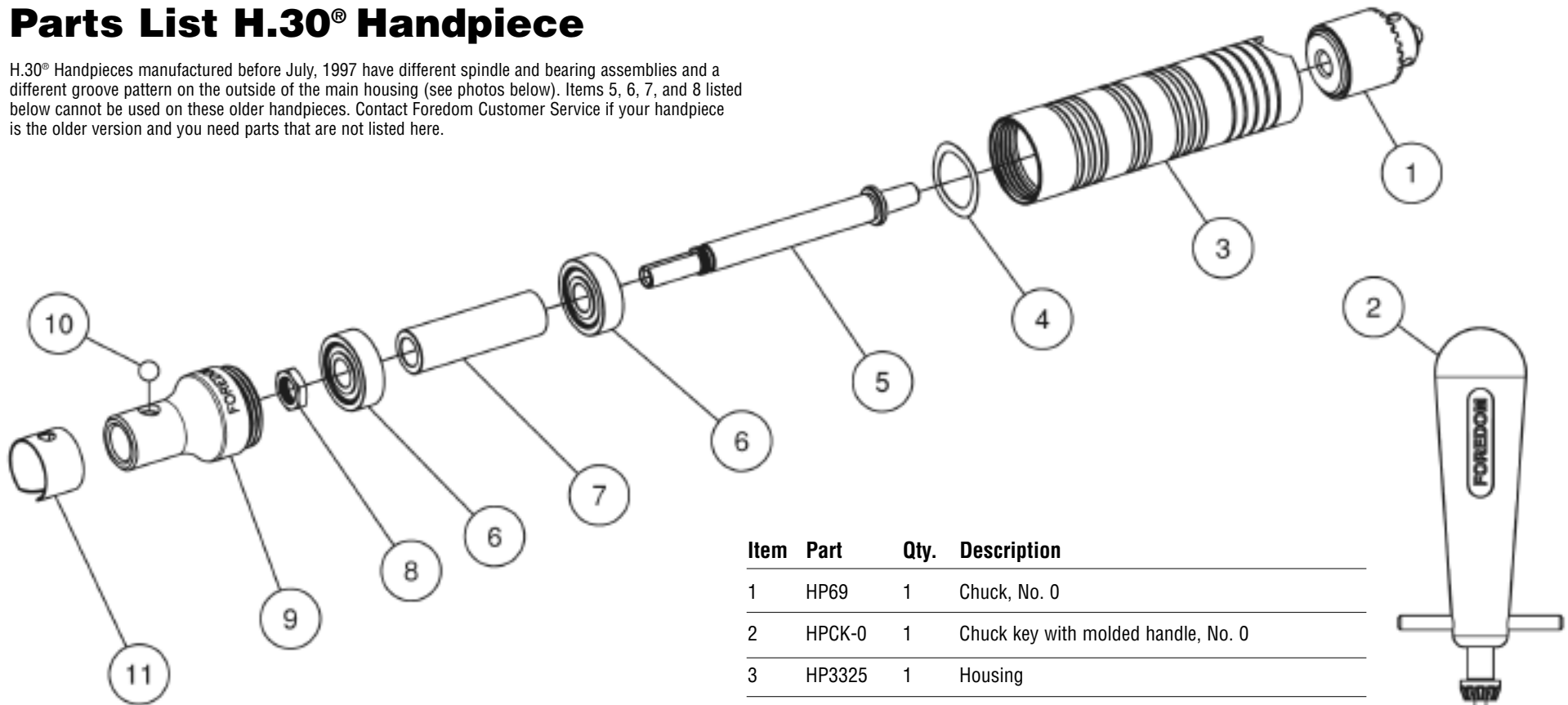

Item	Part	Qty.	Description
1	HP69	1	Chuck, No. 0
2	HPCK-0	1	Chuck key with molded handle, No. 0
3	HP3325	1	Housing
4	HP103103	1	Wavy spring washer
5	HP3327	1	Spindle, No. 30
6	HP61	2	Ball bearing
7	HP3428	1	Bearing spacer
8	HP71	1	Bearing nut
9	HP3324	1	QD connector
10	HP48	1	Catch ball
11	HP43	1	Catch spring



Current H.30<sup>®</sup>  
Handpiece



Old H.30<sup>®</sup>  
Handpiece  
*Groove pattern on  
housing is different.*

## FOREDOM<sup>®</sup>

The Foredom Electric Company, Bethel, CT 06801  
203-792-8622 • Fax: 203-796-7861 • www.foredom.net  
Email: customerservice@blackstoneind.com