

FOREDOM®

The Freedom Electric Company, Bethel, CT 06801
 (203) 792-8622 • Fax: (203) 796-7861 • www.freedom.net
 Email: customerservice@blackstoneind.com

Parts List H.15D Handpiece

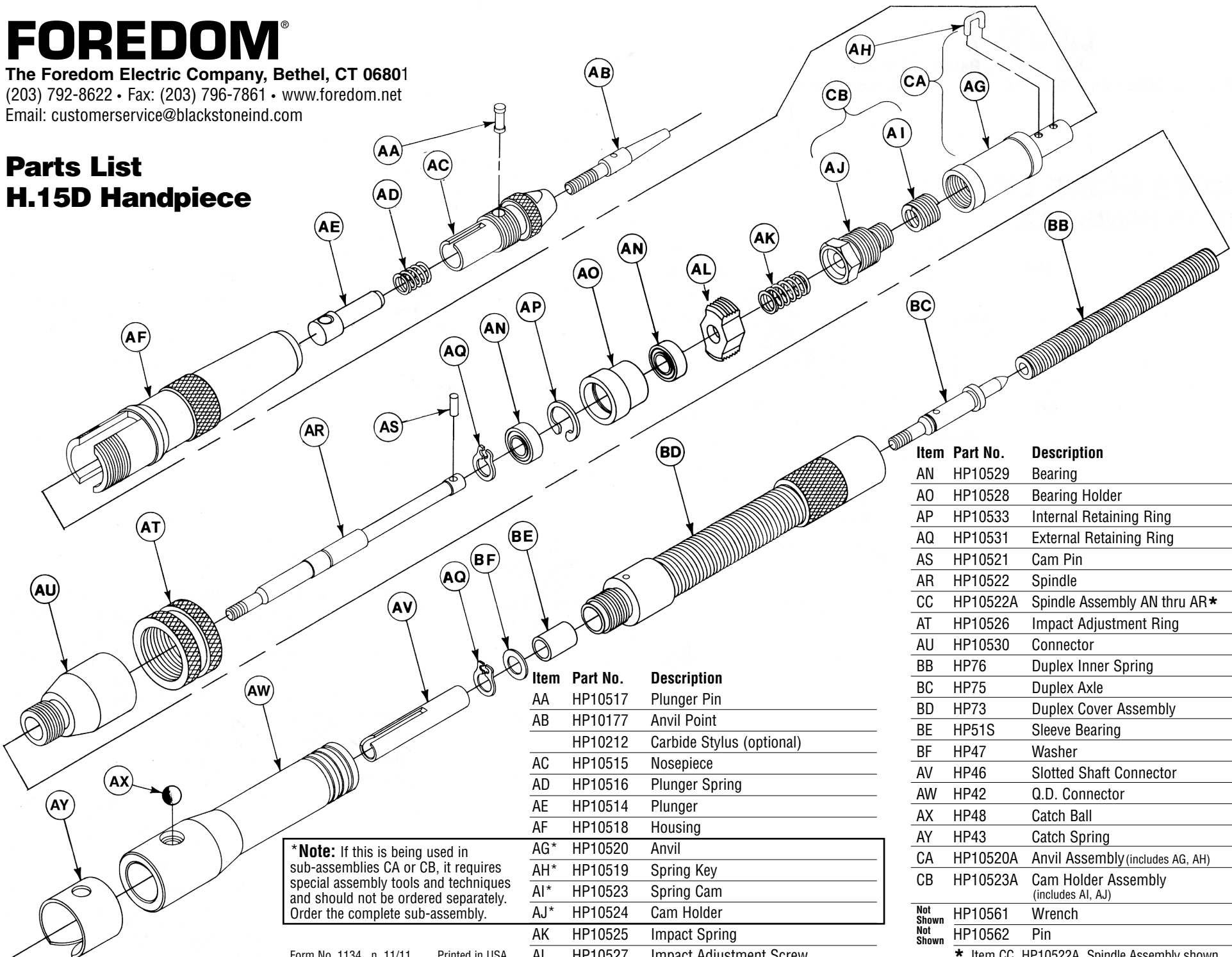

***Note:** If this is being used in sub-assemblies CA or CB, it requires special assembly tools and techniques and should not be ordered separately. Order the complete sub-assembly.

Item	Part No.	Description
AA	HP10517	Plunger Pin
AB	HP10177	Anvil Point
	HP10212	Carbide Stylus (optional)
AC	HP10515	Nosepiece
AD	HP10516	Plunger Spring
AE	HP10514	Plunger
AF	HP10518	Housing
AG*	HP10520	Anvil
AH*	HP10519	Spring Key
AI*	HP10523	Spring Cam
AJ*	HP10524	Cam Holder
AK	HP10525	Impact Spring
AL	HP10527	Impact Adjustment Screw

Item	Part No.	Description
AN	HP10529	Bearing
AO	HP10528	Bearing Holder
AP	HP10533	Internal Retaining Ring
AQ	HP10531	External Retaining Ring
AS	HP10521	Cam Pin
AR	HP10522	Spindle
CC	HP10522A	Spindle Assembly AN thru AR*
AT	HP10526	Impact Adjustment Ring
AU	HP10530	Connector
BB	HP76	Duplex Inner Spring
BC	HP75	Duplex Axle
BD	HP73	Duplex Cover Assembly
BE	HP51S	Sleeve Bearing
BF	HP47	Washer
AV	HP46	Slotted Shaft Connector
AW	HP42	Q.D. Connector
AX	HP48	Catch Ball
AY	HP43	Catch Spring
CA	HP10520A	Anvil Assembly (includes AG, AH)
CB	HP10523A	Cam Holder Assembly (includes AI, AJ)
Not Shown	HP10561	Wrench
Not Shown	HP10562	Pin

* Item CC HP10522A Spindle Assembly shown on page two.

FOREDOM®

The Freedom Electric Company, Bethel, CT 06801
 (203) 792-8622 • Fax: (203) 796-7861 • www.freedom.net
 Email: customerservice@blackstoneind.com

Parts List H.15 Handpiece

Prices subject to
change without notice.

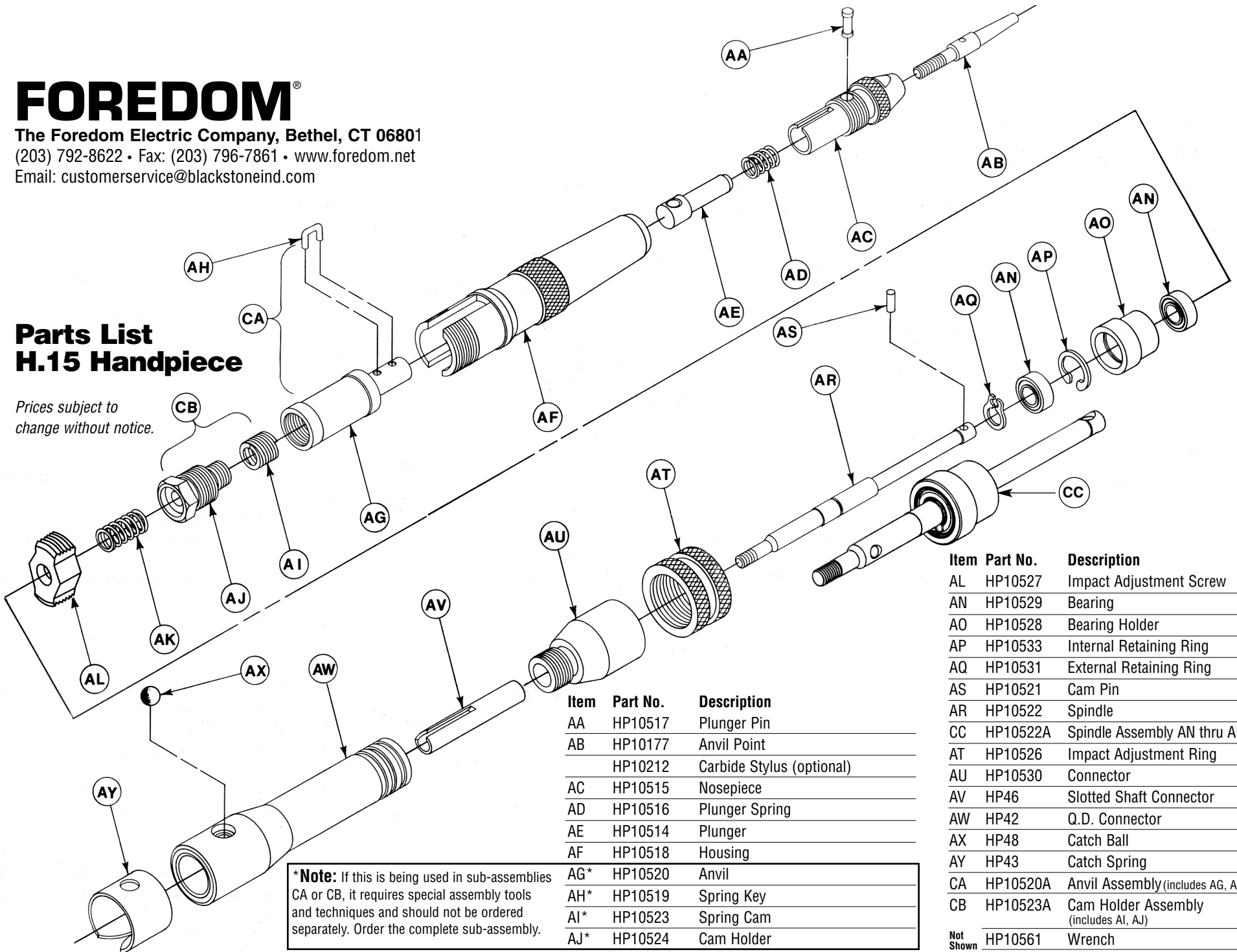

Item	Part No.	Description
AA	HP10517	Plunger Pin
AB	HP10177	Anvil Point
	HP10212	Carbide Stylus (optional)
AC	HP10515	Nosepiece
AD	HP10516	Plunger Spring
AE	HP10514	Plunger
AF	HP10518	Housing
AG*	HP10520	Anvil
AH*	HP10519	Spring Key
AI*	HP10523	Spring Cam
AJ*	HP10524	Cam Holder
AK	HP10525	Impact Spring

***Note:** If this is being used in sub-assemblies CA or CB, it requires special assembly tools and techniques and should not be ordered separately. Order the complete sub-assembly.

Item	Part No.	Description
AL	HP10527	Impact Adjustment Screw
AN	HP10529	Bearing
AO	HP10528	Bearing Holder
AP	HP10533	Internal Retaining Ring
AQ	HP10531	External Retaining Ring
AS	HP10521	Cam Pin
AR	HP10522	Spindle
CC	HP10522A	Spindle Assembly AN thru AR
AT	HP10526	Impact Adjustment Ring
AU	HP10530	Connector
AV	HP46	Slotted Shaft Connector
AW	HP42	Q.D. Connector
AX	HP48	Catch Ball
AY	HP43	Catch Spring
CA	HP10520A	Anvil Assembly (includes AG, AH)
CB	HP10523A	Cam Holder Assembly (includes AI, AJ)
Not Shown	HP10561	Wrench
Not Shown	HP10562	Pin