

# IMPORTANT INSTRUCTIONS

## For Foredom® Handpiece H.30H

*Before attaching this handpiece please read these instructions. They should always be followed to reduce the risk of personal injury or damage to the handpiece.*

*Always use a proper dust collection system or wear a respirator to prevent the inhalation of dust particles, or other debris into the lungs.*

### Repair Service

Factory repairs are done promptly and at reasonable cost. If you wish, you can send your equipment directly to the factory marked "Attention: Repair Department". Be sure to include a brief note describing the problem and to give your phone number, email and street address. Estimates will be made upon request.

*Never wear open shoes or sandals. Use footwear that is tough enough to protect your feet from falling tools.*

*Keep both hands and fingers away from the cutting edge at all times.*

*Always wear proper eye protection while using this handpiece. Wear safety glasses or a face shield whenever you operate a Foredom Flexible Shaft machine or any power tool to prevent serious eye injury.*

*See your power tool owner's manual for complete instructions on use and maintenance.*

*Do not wear loose fitting clothing or jewelry. Loose clothing or jewelry can become entangled in the tool. Do not wear items such as neckties or jewelry when operating power tools. Secure or tie back long hair.*

*Use both hands whenever possible to hold and guide the tool.*

*Never use a damaged, bent, vibrating, or out of balance accessory.*

*Avoid knots, imperfections in the wood or metal objects like nails, which could catch or damage the tool bit. Let the speed of the tool do the work.*

### Attaching H.30H Handpiece to the Flexible Shaft

It takes a fairly strong grasp of the locking ring to pull it back.

**Be careful that your finger or thumb does not get pinched when you release the locking ring.**

Pull back the black locking ring toward the front end of the handpiece while you insert the tip of the flex shaft. The handpiece has a square slot that the square drive tip fits into. You may need to rotate the handpiece slightly until the square drive engages the spindle. Release the locking ring when you feel the shaft connect to the handpiece. You should hear a click.

### To remove handpiece

Pull back the locking ring as described above with a firm grip and pull the shaft and sheath from the handpiece.

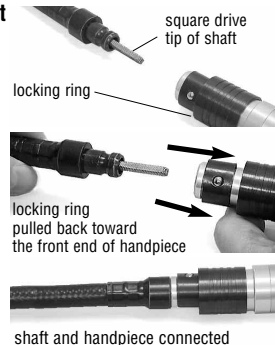

**For more information** on this handpiece and other Foredom tools, contact your local dealer. When no local dealer is available, write: The Foredom Electric Co., 16 Stony Hill Rd., Bethel, CT 06801, call (203) 792-8622, fax (203) 796-7861, or email: [customerservice@blackstoneind.com](mailto:customerservice@blackstoneind.com).

**Visit [www.foredom.net](http://www.foredom.net) for the latest information and how-to videos!**

### Maintenance and Lubrication

**Handpieces:** no lubrication is required. Putting oil or grease into the front or back of these handpieces will damage their pre-lubricated ball bearings. The chuck of the handpiece should be kept free of dirt, chips, dust or debris.

**Flexible Shaft:** *Every 50 hours of use:* Unscrew outer sheath connector nut (left hand thread) and remove sheath.

*Flexible Shaft Maintenance continued on reverse*



## Lubrication of Flexible Shaft continued:

The shaft is threaded through both a silencer spring and the outer sheath. Slide both the outer sheath and the silencer spring off of the flexible shaft. Usually the silencer spring remains inside the sheath when you remove it.

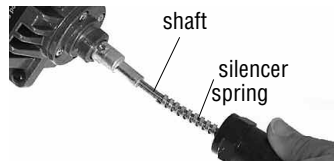

The flexible shaft should be thoroughly cleaned with a solvent. Apply a **light film** of Freedom grease (MS10006) to entire length of inner shaft. **Reattach outer sheath** and run motor for ten minutes before reconnecting handpiece. Turn off motor, wipe off excess grease from tip of drive shaft and reconnect to handpiece per instructions on reverse.



## Changing Accessories

These handpieces have a geared 3-jaw #0 chuck. Open chuck jaws as far as necessary with key provided. Insert shank of accessory fully into the chuck. Tighten each of the jaws with chuck key until accessory is secure and centered. If accessory does not run true, reopen jaws, rotate accessory and retighten. To release accessory, simply reopen chuck jaws with key and pull out accessory.

## Handpiece Accessories and Spare Parts

MAHH-30



A Handpiece Holder is available that clamps to work benches up to 2 1/4" thick. The height above the bench can be adjusted and the handpiece can be swiveled and locked into position. Chuck Keys that are lost or damaged can be ordered from your dealer or the factory.

Part No.	Description
MAHH-30	Handpiece Holder
HPCK-0	Chuck Key with plastic handle
HP72	Chuck Key

## Go to [www.foreedom.net](http://www.foreedom.net) to find out about bench top tools that make the H.30H handpiece even more versatile!

These include drill presses, handpiece holder, belt sander attachment, angle grinder, collet adapter and the AllSet® attachment for stone setting.

### LIMITED WARRANTY

Warranty period is 90 days for handpieces.

Blackstone Industries, Inc. d/b/a The Freedom Electric Company warrants, to the original purchaser only, that its products will be free from defects in material or workmanship for the applicable period of time indicated above following the purchase date. During the warranty period, the defective product will be repaired or replaced without charge or, at our sole option, the purchase price will be refunded. This warranty does not cover damage caused in transit or by accident, misuse or ordinary wear.

ALL IMPLIED WARRANTIES INCLUDING, WITHOUT LIMITATION, IMPLIED WARRANTIES OF FITNESS FOR A PARTICULAR PURPOSE AND MERCHANTABILITY, ARE LIMITED IN DURATION TO THE APPLICABLE WARRANTY PERIOD. IN NO EVENT WILL WE BE LIABLE FOR ANY INCIDENTAL OR CONSEQUENTIAL DAMAGES. Some states do not allow limitations on how long an implied warranty lasts or the exclusion or limitation of incidental or consequential damages, so the above limitations or exclusion may not apply to you.

At our sole option, repair, replacement or refund will be made if the product is returned postage prepaid to:

### The Freedom Electric Company

16 Stony Hill Road, Bethel, Connecticut 06801

All warranty repairs must be done at our factory at the above address. We will not pay any shipping or transportation charges. Shafts, sheaths and duplex springs are not covered by this warranty.

This warranty gives you specific legal rights, and you may also have other rights which vary from state to state.