

Assembly List

MALC30

Jumbo Work Chamber with Magnetic LED Light

Item	Description	Qty
1	Top Panel	1
2	Shield Hinge	2
3	M5x6mm Screw	32
4	LED Light Box	1
5	Elbow, 2 1/4"	1
6	Back Panel	1
7	Right Panel	1
8	Tray	1
9	Bottom Panel	1
10	LED Light	1
11	Front Panel with Shield	1
12	Left Panel	1
13	Cordset, Detachable	1

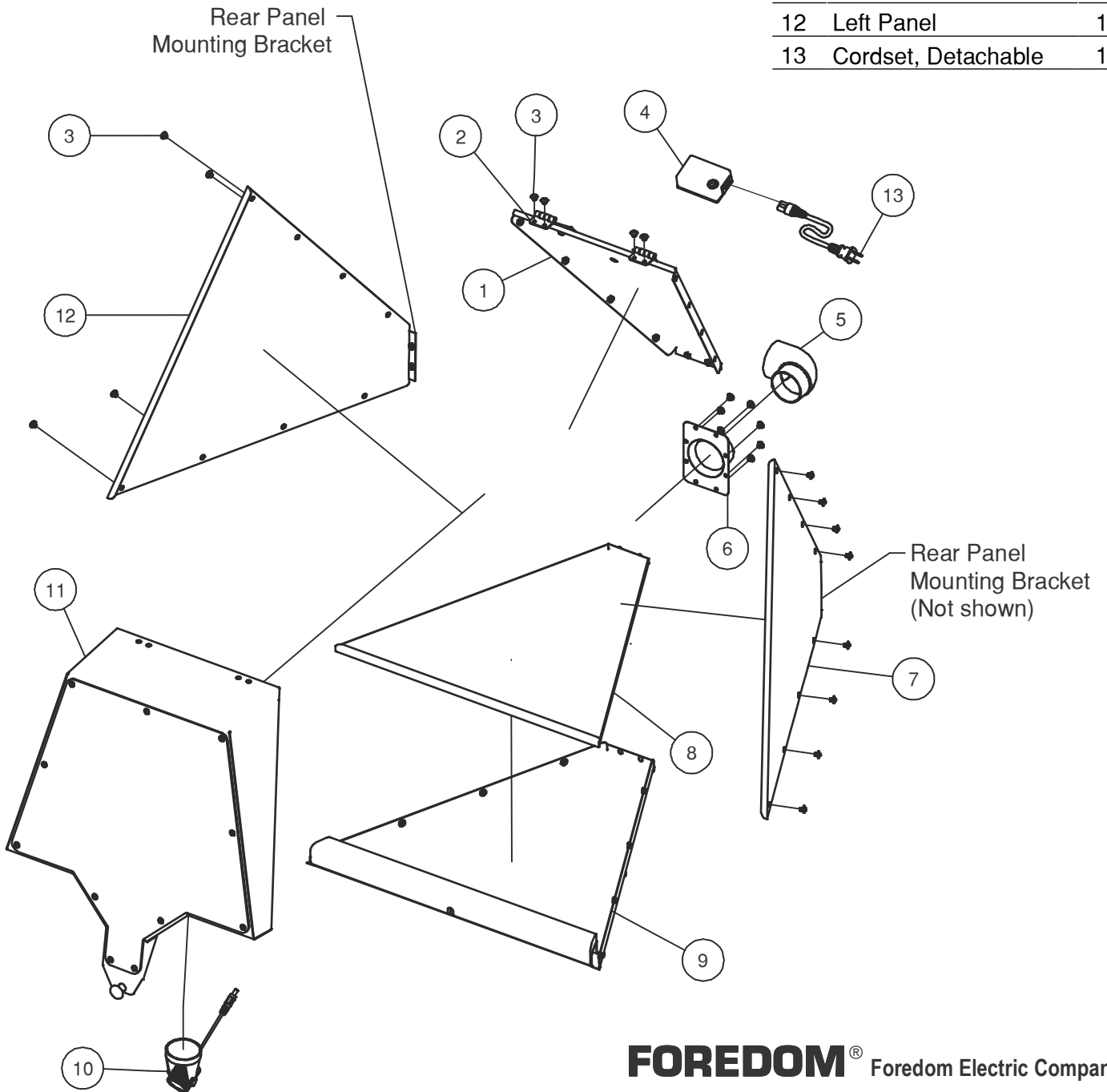

Assembly List

MALC30

Jumbo Work Chamber with Magnetic LED Light

Jumbo Work Chamber Assembly Instructions

Tools required: No. 2 Phillips Screwdriver

1. Place the Bottom Panel (Item 9) on a flat surface and attach the bottom section of the Right Panel (Item 7) by threading four M5x6mm Screws (Item 3) through the aligned holes using the No. 2 Phillips Screwdriver. Do not fully tighten the screws until step 5.
2. Repeat Step 1 with the Left Panel (Item 12).
3. Attach the Top Panel (Item 1) to the side panels by threading eight M5x6mm Screws (Item 3) through the aligned holes. The Top Panel is attached to the Left and Right Panels by four screws each.
4. Attach the Back Panel to the four large panels by threading eight total M5x6mm Screws (Item 3) through the aligned holes. The Back Panel is attached to each of the four panels by two screws each.
5. Flush up the five panels and tighten the 24 screws connecting them.
6. Attach the Shield Assembly (Item 11) to the top panel through the Shield Hinge (Item 2). Thread four M5x6mm Screws (Item 3) through the Shield Hinges, two screws for each of the two hinges.
7. Lift up the Shield Assembly (Item 11) to allow for the Tray (Item 8) to be placed on top of the Bottom Panel (Item 9). Also place the magnetic LED Light (Item 10) inside the Shield Assembly where desired.
8. Place the magnetic LED Light Box (Item 4) on the outside of the chamber. Feed the wire from the LED Light (Item 10) through the hole in the top panel and insert the cord into the LED Light Box. Insert the Cordset into the LED Light Box (Item 4).
9. Insert the Elbow Tube (Item 5) into the Back Panel (Item 6).

Parts List

MALC30

Jumbo Work Chamber with Magnetic LED Light

Item	Part No.	Description	Qty
1	---	Top Panel Assembly	1
1.1		Top Panel	1
1.2		Bushing	1
2	---	Shield Hinge	2
3	---	M5x6mm Screw	32
4	---	Handle	1
5	---	M5x12mm Screw	2
6	---	M5 Nut	2
7	CP10594	Switch Box, LED	1
8	CP10595	Cordset, Detachable	1
9	MA825	Elbow, 2 1/4"	1
10	---	Back Panel	1
11	---	Right Panel	1
12	---	Tray	1
13	---	Bottom Panel	1
14	MA303	Arm Rest	1
15	MA304	Bottom Pad	7
16	---	LED Light	1
17.1	---	Knob	1
17.2	---	Centering Pin	1
18	MA301	Shield	1
19	---	M4x6mm Screw	11
20	---	Shield Frame	1
21	---	Left Panel	1
22	MA302	Frame Gasket	1

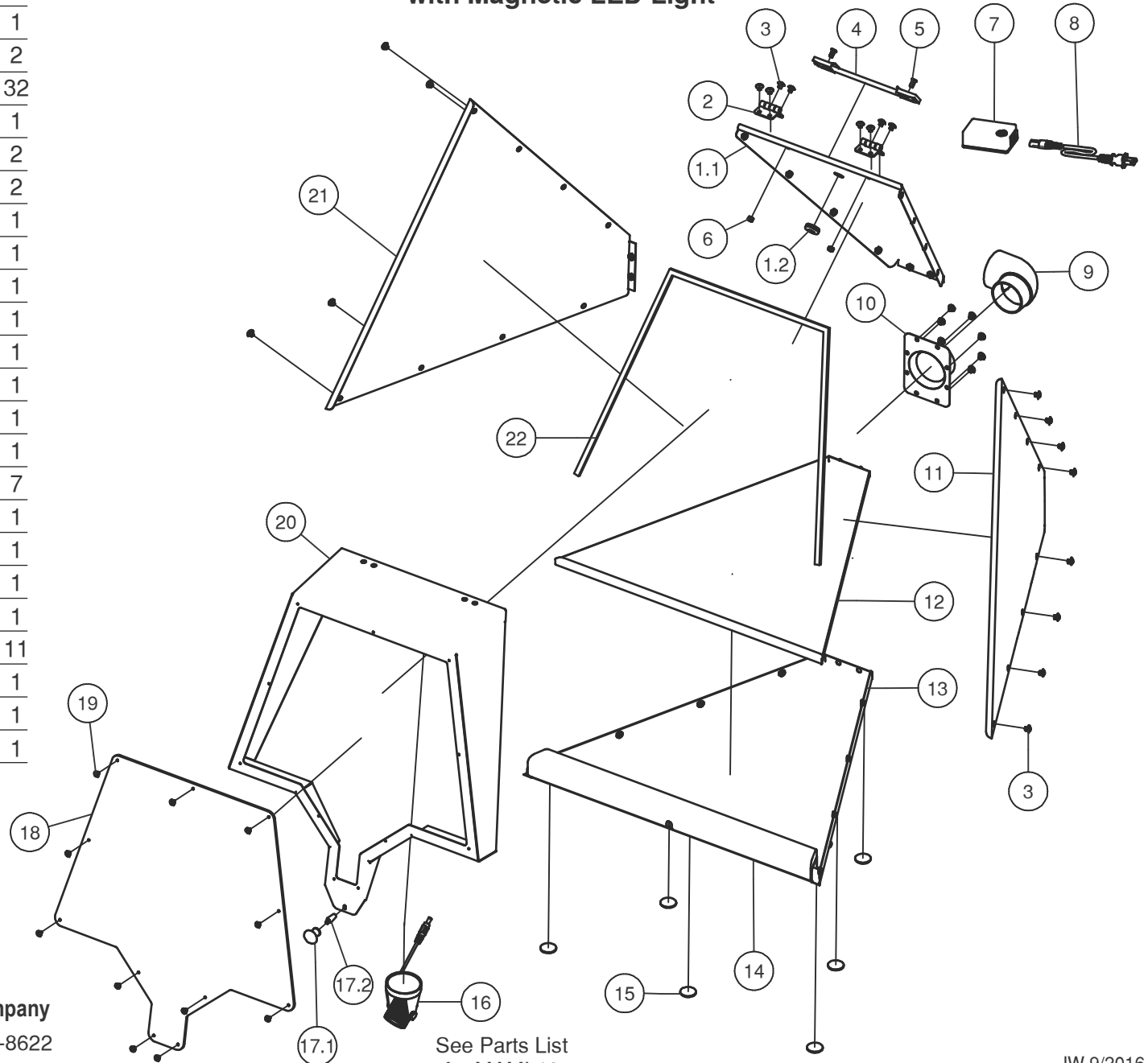

FOREDOM® Freedom Electric Company

16 Stony Hill Rd., Bethel, CT 06801 • 203-792-8622
 Fax: 203-796-7861 • www.foredom.net

See Parts List
for MAML10

JW 9/2016