

# IMPORTANT INSTRUCTIONS Freedom® Handpieces H.8, H.8D, H.8SJ, H.28, H.28SJ, H.43T, H.44T, and H.44TSJ

**Before attaching this handpiece please read these instructions. They should always be followed to reduce the risk of personal injury or damage to the handpiece.**

**Always use a proper dust collection system or wear a respirator to prevent the inhalation of dust particles, or other debris into the lungs.**

## Repair Service

Factory repairs are done promptly and at reasonable cost. If you wish, you can send your equipment directly to the factory marked "Attention: Repair Department". Be sure to include a brief note describing the problem and to give your phone number, email and street addresses. Estimates will be made upon request.

**Never wear open shoes or sandals when using a power tool. Use footwear that is tough enough to protect your feet from falling tools.**

**Keep both hands and fingers away from the cutting edge at all times.**

**Always wear proper eye protection while using this handpiece. Wear safety glasses or a face shield whenever you operate a Freedom Flexible Shaft machine or any power tool to prevent serious eye injury.**

**See your power tool owner's manual for complete instructions on use and maintenance.**

**Do not wear loose fitting clothing or jewelry.**

**Loose clothing or jewelry can be come entangled in the tool. Do not wear items such as neckties or jewelry when operating power tools. Secure or tie back long hair.**

**Use both hands whenever possible to hold and guide the tool.**

**Avoid knots, imperfections in the wood or metal objects like nails, which could catch or damage the tool. Let the speed of the tool do the work.**

**Never use a damaged, bent, vibrating, or out of balance accessory.**

F-1239 n 4/21

Printed in USA

## Changing Accessories

**Be sure the shank size of the accessory is paired with the same size collet. Inserting an accessory which is too small or too large may damage the collet.**

### Handpieces H.28, H.28SJ, H.43T, H.44T, and H.44TSJ

Insert the pin provided into the pilot hole and through the spindle hole (turn spindle to align holes). Apply wrench and loosen chuck nut slightly by turning counterclockwise. Insert shank of the accessory into the collet. Tighten chuck nut with wrench, keeping pin in pilot hole. Test for a secure hold by pulling on accessory. **Remove pin.**



### Handpieces H.8, H.8D, and H.8SJ

These handpieces have a chuck guard that slides back when changing collets and accessories. They come with two chuck wrenches for opening and closing the collet. Use one wrench to hold the spindle and the other to unscrew the chuck nut by turning counterclockwise.



## Collets

The different size collets that come with your handpiece are for holding burs and other accessories with different shank sizes.



Chuck Nut and Collet

**Never screw the chuck nut back on too tightly. If you tighten an empty collet or insert an accessory shank which is too small or too large you may damage the collet.**

## Changing Collets

### Handpieces H.28, H.28SJ, H.43T, H.44T, and H.44TSJ

To change a collet insert pin into the pilot hole and through the spindle hole (turn spindle to align holes). Apply wrench and unscrew chuck nut by turning counterclockwise. Remove chuck nut to expose collet and pull collet out of handpiece shaft. Slip new size collet in place and screw on chuck nut with pin and wrench.



Pliers are useful for removing collets

**Handpieces H.8, H.8D, and H.8SJ** To change a collet, slide back the chuck guard and use one wrench to hold the spindle and the other to unscrew the chuck nut by turning counterclockwise. Remove chuck nut to expose collet and pull collet out of handpiece shaft. Slip new size collet in place and tighten chuck nut with wrenches.

## For more information on this handpiece

and other Freedom tools, contact your local dealer.

When no local dealer is available, write:

**Freedom Electric Co.** 16 Stony Hill Road, Bethel, CT 06801  
call (203) 792-8622, fax (203) 796-7861, or email:  
customerservice@blackstoneind.com

**Visit [www.foreedom.net](http://www.foreedom.net) for the latest information and how-to videos!**

## Adjust the Shaft and Sheath

It is important to check the sheath and shaft tip and properly adjust them before attaching this handpiece to your Freedom flex shaft tool. The tip of the flexible shaft should extend 3/4" beyond the end of the sheath. This adjustment is made by loosening the set screw in the motor connector and moving the sheath in or out while the motor and shaft/sheath are hanging fully extended or laying on a flat surface. When the shaft is adjusted correctly, tighten the set screw in the motor connector.

**Always make sure your power tool is unplugged during any maintenance procedure.**

## To Attach Handpiece to Flexible Shaft:

**Before attaching the handpiece, connect the motor to the speed control and plug into power source.**

While holding the black colored metal outer sheath tip facing upward, turn on the control so that the motor is running at about half speed and then turn it off. While the inner key tip is still rotating, grip the handpiece and push it onto the sheath tip with one firm motion until it snaps into place (shown at right). This procedure will align the key tip into the keyway slot. To verify this, insert and tighten an accessory into collet, turn on control to a low speed and observe that the accessory rotates smoothly.

## To Remove Handpiece from Flexible Shaft:

**First make sure your power tool is unplugged** and then, simply pull the handpiece off the shaft and sheath with a firm grip.

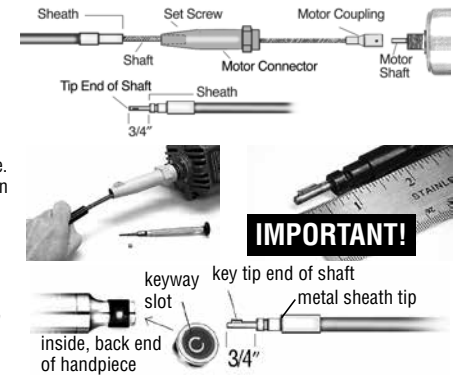

**IMPORTANT!**

**This information does not apply to slip joint connections.** H.44TSJ, H.28SJ and H.8SJ handpieces have a 'slip joint' connection for use with European style machines.

## Maintenance and Lubrication

**These handpieces do not require any lubrication except for the duplex spring on the H.8D Handpiece.** Putting oil or grease into the front or back will damage its prelubricated ball bearings. Periodically remove the chuck nut and collet and clean the collet holder seat and threads of dust or debris with a bristle brush or air gun.



**Lubrication of H.8D Duplex Connection** — Apply 2 drops of oil (p/n MS10005) in the oil hole in the rear of the duplex connection after every 20 hours of use.

## Collets for H.8, H.8D, H.8SJ, H.28, and H.28SJ

P/N	Capacity	P/N	Capacity
HP601	1/32"	HP604	1/8" *
HP602	1/16"	HP605	3mm
HP603	3/32" *	*Supplied with handpieces above. HP600 Set Includes all but HP605.	

## Collets for H.43T, H.44T, and H.44TSJ

P/N	Capacity	P/N	Capacity
HP442	3/32"*	HP447	1/4"*
HP443	1/8"*	HP448	3mm
HP444	5/32"	HP449	6mm
HP445	3/16"	*Supplied with handpieces above. HP440 Set Includes each collet listed above.	

## Handpiece Accessories & Spare Parts

A Handpiece Holder clamps to work benches up to 2 1/4" thick. The height above the bench can be adjusted and the handpiece can be swiveled and locked into position. Pins and wrenches that are lost or damaged can be ordered from your dealer or the factory.



MAHH-30

Part No.	Description	Use with Handpieces
MAHH-30	Handpiece Holder	H.43T, H.44T, H.44TSJ
HP103117	Pin and Wrench	H.44T, H.44TSJ, H.43T
HP10588	Pin and Wrench	H.28, H.28SJ
HP10586	Set of 2 Wrenches	H.8, H.8D, H.8SJ

## LIMITED WARRANTY

Warranty period is 90 days for handpieces.

Blackstone Industries, LLC d/b/a Freedom Electric Company warrants, to the original purchaser only, that its products will be free from defects in material or workmanship for the applicable period of time indicated above following the purchase date. During the warranty period, the defective product will be repaired or replaced without charge or, at our sole option, the purchase price will be refunded. This warranty does not cover damage caused in transit or by accident, misuse or ordinary wear.

ALL IMPLIED WARRANTIES INCLUDING, WITHOUT LIMITATION, IMPLIED WARRANTIES OF FITNESS FOR A PARTICULAR PURPOSE AND MERCHANTABILITY, ARE LIMITED IN DURATION TO THE APPLICABLE WARRANTY PERIOD. IN NO EVENT WILL WE BE LIABLE FOR ANY INCIDENTAL OR CONSEQUENTIAL DAMAGES. Some states do not allow limitations on how long an implied warranty lasts or the exclusion or limitation of incidental or consequential damages, so the above limitations or exclusion may not apply to you.

At our sole option, repair, replacement or refund will be made if the product is returned postage prepaid to:

**Freedom Electric Company**  
16 Stony Hill Road, Bethel, Connecticut 06801

All warranty repairs must be done at our factory at the above address. We will not pay any shipping or transportation charges. Shafts, sheaths and duplex springs are not covered by this warranty. This warranty gives you specific legal rights, and you may also have other rights which vary from state to state.