

Parts List

MALC30

Jumbo Work Chamber with Magnetic LED Light

Item	Part No.	Description	Qty
1	---	Top Panel Assembly	1
1.1		Top Panel	1
1.2		Bushing	1
2	---	Shield Hinge	2
3	---	M5x6mm Screw	32
4	---	Handle	1
5	---	M5x12mm Screw	2
6	---	M5 Nut	2
7	CP10594	Switch Box, LED	1
8	CP10595	Cordset, Detachable	1
9	MA825	Elbow, 2 1/4"	1
10	---	Back Panel	1
11	---	Right Panel	1
12	---	Tray	1
13	---	Bottom Panel	1
14	MA303	Arm Rest	1
15	MA304	Bottom Pad	7
16	---	LED Light	1
17.1	---	Knob	1
17.2	---	Centering Pin	1
18	MA301	Shield	1
19	---	M4x6mm Screw	11
20	---	Shield Frame	1
21	---	Left Panel	1
22	MA302	Frame Gasket	1

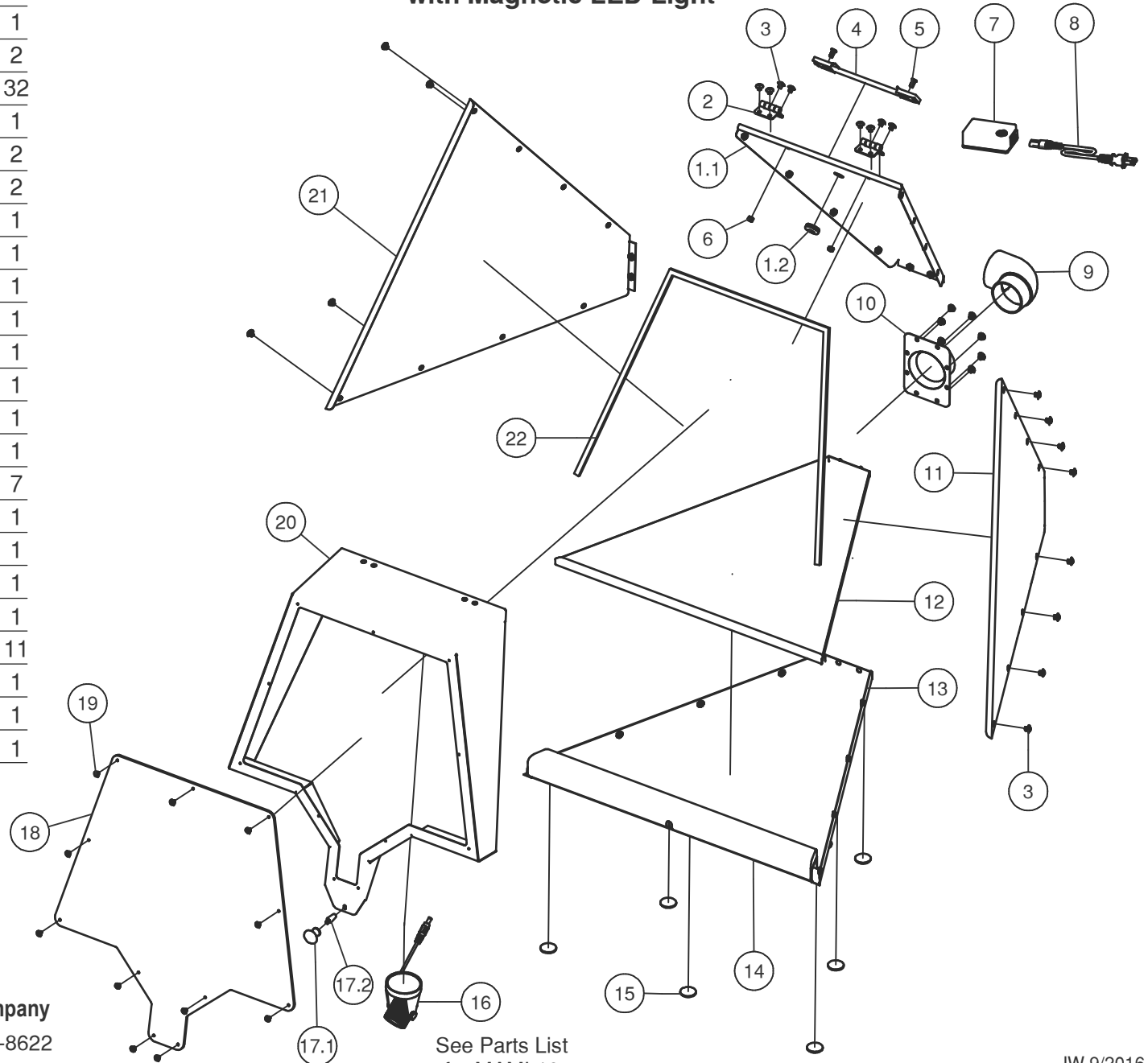

FOREDOM® Freedom Electric Company

16 Stony Hill Rd., Bethel, CT 06801 • 203-792-8622
 Fax: 203-796-7861 • www.foredom.net

See Parts List
for MAML10

JW 9/2016