

Parts List

H.35 Handpiece

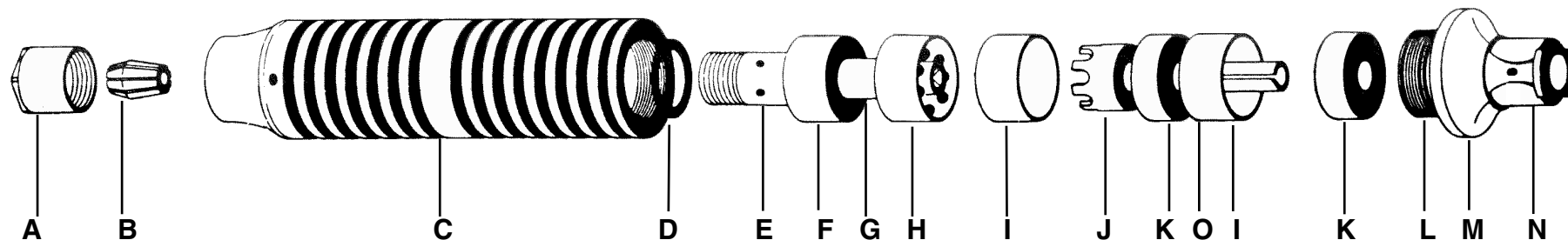

Item	Part	Description
	HP 103117	Pin and Wrench
	HP 103125	Socket Screw Key
A	HP 103105	Chuck Nut
B	HP 103114	Collet for 1/8" Shanks
	HP 103113	Collet for 3/16" Shanks
	HP 103115	Collet for 3/32" Shanks
	HP 103116	Collet for 1/16" Shanks
	HP 103124	Collet for 3.00 mm Shanks
	HP 103126	Collet for 4.00 mm Shanks
C	HP 103101	Housing
D	HP 103103	Wavy Spring Thrust Washer
E	HP 103106	Spindle (Not incl. items F, G, & H)

Item	Part	Description
F	HP 103121	Front Bearing
G	HP 103107-2	Spacer
H	HP 103122	Drive Bearing
I	HP 103108	Thrust Ring (2 required)
J	HP 103111	Ball Drive Assembly (Not incl. items K, & I)
K	HP 103120	Rear Bearing (2 required)
L	HP 103102	Sheath connector (Not incl. items M,N, & HP48)
M	HP 103123	Socket Set Screw
N	HP 43	Catch Spring
-	HP 48	Catch Ball
O	HP 103107-4	Spacer

FOREDOM®
The Foredom Electric Company

16 Stony Hill Road, Bethel, CT 06801, USA

Tel.: 203-792-8622 • Fax: 203-796-7861

www.foredom.net • Email: customerservice@blackstoneind.com

Operation and Service of the H.35 Handpiece

Please Read These Instructions Before Using Your H.35 Handpiece

This precision handpiece was designed for use with Foredom and other makes of flexible shaft machines. It contains a ball bearing speed increaser which multiplies the motor speed 2.5 times. The maximum speed of an accessory in the handpiece is therefore, 35,000 RPM when used on a machine running at 14,000 RPM.

Many Foredom machines have maximum speeds of over 14,000 RPM therefore it is advisable to use the H.35 handpiece at less than full motor speed in order to avoid overheating of bearings.

Safety Instructions

1. Because of it's planetary drive mechanism, this handpiece is particularly sensitive to side loading. **Do not apply excessive pressure. Apply only light or moderate pressure to the accessory on the work. Let the speed of the handpiece do the work. The No. 35 should not be used with 6 mm or 1/4" collets.**
3. Use only a light film of Foredom Flexible Shaft Grease (Part No. 10006) to lubricate the flexible shaft. Run motor for a minute or two before reconnecting handpiece. Turn off motor, wipe off any excess grease from tip of drive shaft and reconnect handpiece.
3. Use safety glasses at all times.
4. Do not use the handpiece at motor speeds over 14,000 RPM.
5. If the handpiece stalls (the accessory stops turning), **immediately** remove the handpiece from the work and allow the handpiece to re-engage. This can be accomplished while the handpiece is in operation. It is also an indication that excessive pressure is being applied to the handpiece.

Maintenance and Service

1. **Do not try to lubricate handpiece.** The handpiece is permanently lubricated and requires no lubrication.
2. Return the handpiece to the dealer or directly to the factory for service.
3. Recommended to keep on hand:
Foredom Flexible Shaft Grease (Part No. 10006)

Instructions for Removing Collet

Loosen and remove chuck nut with the 1/2" open end wrench supplied with the handpiece. If collet is difficult to remove by hand, insert the shank of a mandrel, grinding stone, bur or other accessory into the collet. Tap side of accessory lightly with wrench until collet is loosened. Remove collet. **Do not tighten chuck nut down on an empty collet!** This may crack or stress the collet, or may cause the collet to stick in the handpiece. **Do not use undersized or oversized shanks in collet.** Always match shank and collet sizes.

FOREDOM®

The Foredom Electric Company

16 Stony Hill Road, Bethel, CT 06801, USA

Tel.: 203-792-8622 • Fax: 203-796-7861

www.foredom.net • Email: customerservice@blackstoneind.com