

# Parts List H.25 Handpiece

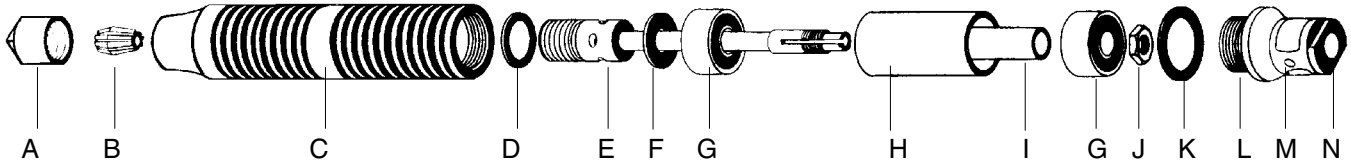

Item	Description	Part No.
A	Chuck Nut	HP103105
B	Collet for 1/4" Shanks	HP103112
	Collet for 3/16" Shanks	HP103113
	Collet for 1/8" Shanks	HP103114
	Collet for 3/32" Shanks	HP103115
	Collet for 1/16" Shanks	HP103116
	Collet for 6mm Shanks	HP103119
	Collet for 3mm Shanks	HP103124
	Collet for 4mm Shanks	HP103126
	<b>Set of 5 Collets</b> (1/16", 3/32", 1/8", 3/16", 1/4")	HP103000
C	Housing	HP10470
D	Dust Cap	HP10445
E	Spindle	HP10444
F	Baffle Washer	HP10446
G	Ball Bearing (2 required)	HP103121
H	Outer Spacer	HP10448
I	Inner Spacer	HP10447
J	Bearing Retainer Nut	HP71
K	Thrust Washer	HP103103
L	Sheath Connector (not including items M, N, and HP48)	HP10471
M	Socket Set Screw	HP103123
N	Sheath Catch Spring	HP43
-	Ball for Sheath Catch Spring	HP48
-	Pin and Wrench	HP103117
-	Socket Screw Key	HP103125

**Please read these instructions  
before using the H.25 Handpiece**

### Operation and Safety Instructions

1. This precision handpiece was designed for use with Foredom Flexible Shaft Machines. Attach the handpiece to the flexible shaft by aligning the key of the shaft tip with the slot in the shaft connector of the handpiece. Then push the handpiece onto the sheath tip until the ball in the sheath connector drops into the groove in the sheath tip. Now tighten the set screw (Item M in the parts list) in the sheath connector.

2. **Use only accessories (burs, cutters, etc.) rated for use at 18,000 RPM.** Always check the manufacturer's recommendations and be sure that the accessory shank size matches the collet size. Undersize shanks will damage the collet and the accessories will not run true.

3. Use safety glasses at all times.

4. Do not use the handpiece on motors with speeds over 18,000 RPM.

### Instructions for Removing Collet

Loosen chuck nut with the 1/2" wrench supplied with the handpiece. If collet is difficult to remove by hand, insert the shank of a mandrel, grinding stone, bur or other accessory into the collet. Tap side of accessory lightly with wrench until collet is loosened. Remove collet. **Do not tighten chuck nut down on an empty collet!** This may crack or stress the collet, or may cause the collet to stick in handpiece. **Do not use undersized or oversized shanks in collet.** Always match shank and collet sizes.

### Maintenance and Service

1. **Do not try to lubricate the handpiece.** The handpiece is permanently lubricated and requires no lubrication.

2. Use only Foredom Flexible Shaft Grease (P/N 10006) to lubricate the flexible shaft. It will not liquefy and run down the shaft into the handpiece.

3. Return the handpiece to the dealer or directly to the factory for service.

# FOREDOM®

The Foredom Electric Company

16 Stony Hill Road, Bethel, CT 06801 • 203-792-8622 • Fax: 203-796-7861

www.foredom.net • Email: customerservice@blackstoneind.com