

Parts List

H.35SJ Handpiece

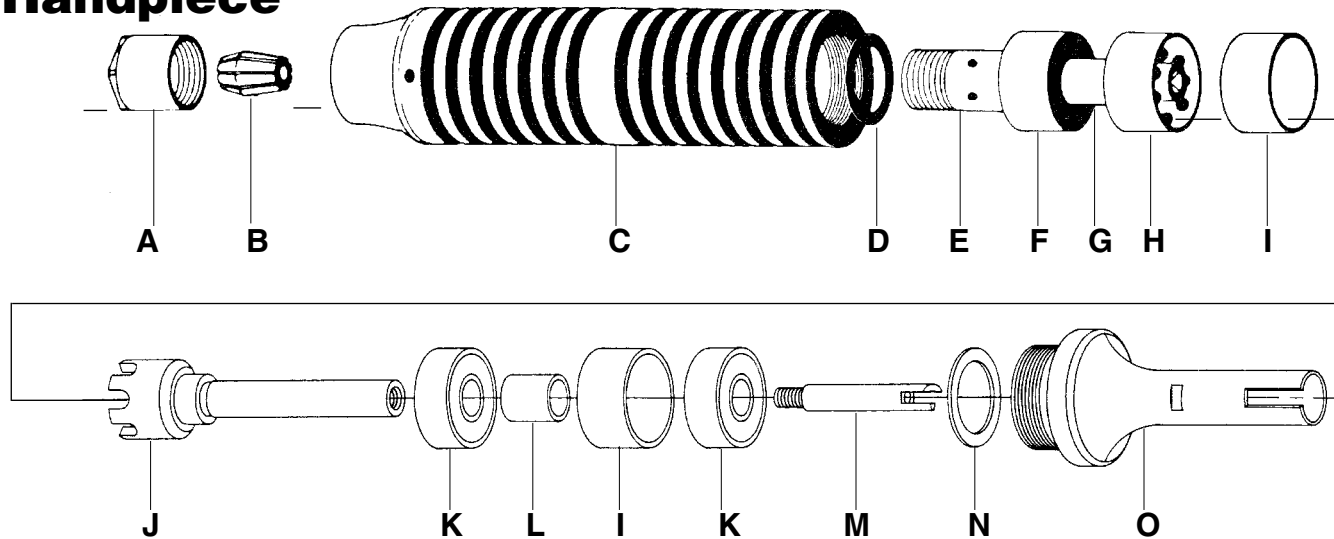

Item	Part	Description
	HP 103117	Pin and Wrench
	HP 103125	Socket Screw Key
A	HP 103105	Chuck Nut
B	HP 103113	Collet for 3/16" Shanks
	HP 103114	Collet for 1/8" Shanks
	HP 103115	Collet for 3/32" Shanks
	HP 103116	Collet for 1/16" Shanks
	HP 103124	Collet for 3.00 mm Shanks
	HP 103126	Collet for 4.00 mm Shanks
C	HP 103101	Housing
D	HP 103103	Wavy Thrust Washer

Item	Part	Description
E	HP103106	Spindle
F	HP 103121	Front Bearing
G	HP 103107-2	Spacer
H	HP 103122	Drive Bearing
I	HP 103108	Thrust Ring (2 required)
J	HP 103135	Slip Joint Drive Shaft Assembly
K	HP 103120	Rear Bearing (2 required)
L	HP 103107-4	Spacer .404
M	HP 10727	Slip Joint Shaft Connector
N	HP 103128	Shim Washer
O	HP 103132	Slip Joint QD Connector, #35

FOREDOM®

The Freedom Electric Company 16 Stony Hill Road, Bethel, CT 06801, USA

Tel.: 203-792-8622 • Fax: 203-796-7861 • www.freedom.net • Email: customerservice@blackstoneind.com

Printed in U.S.A.

Form 1131A 11/11

Operation and Service of the H.35SJ Handpiece

Please Read These Instructions Before Using Your H.35SJ Handpiece

This precision handpiece was designed for use with flexible shaft machines that have the European style 'slip joint' connection. It contains a ball bearing speed increaser which multiplies the motor speed 2.5 times. The speed of an accessory in the handpiece is therefore, 35,000 RPM when used on a machine running at 14,000 RPM. The handpiece should not be run at speeds above 35,000 RPM.

Many flexible shaft machines have maximum speeds of over 14,000 RPM. Use the H.35SJ Handpiece at less than full motor speed in order to avoid overheating of bearings if the motor has a maximum speed of more than 14,000 RPM.

Safety Instructions

1. Because of its planetary drive mechanism, this handpiece is particularly sensitive to side loading. **Do not apply excessive pressure.** Apply only light or moderate pressure to the accessory on the work. Let the speed of the handpiece do the work. The H.35 SJ should not be used with 6 mm or 1/4" collets.
2. Use safety glasses at all times.
3. Do not use the handpiece at motor speeds over 14,000 RPM.
4. If the handpiece stalls (the accessory stops turning), **immediately** remove the handpiece from the work and allow the handpiece to re-engage. This can be accomplished while the handpiece is in operation. It is also an indication that excessive pressure is being applied to the handpiece.

FOREDOM®

The Foredom Electric Company 16 Stony Hill Road, Bethel, CT 06801, USA

Tel.: 203-792-8622 • Fax: 203-796-7861 • www.foredom.net

Email: customerservice@blackstoneind.com

Maintenance and Service

1. **Do not try to lubricate handpiece.** The handpiece is permanently lubricated and requires no lubrication.
2. Return the handpiece to the dealer or directly to the factory for service.
3. Recommended spare parts to keep on hand:
Set of 5 Collets (P/N 103000-35) containing: 1.6mm (1/16"), 2.35mm (3/32"), 4.8mm (3/16"), 3mm and 4mm collets.

Instructions for Removing Collet

Loosen and remove chuck nut with the 1/2" open end wrench supplied with the handpiece after inserting the spindle locking pin through the hole in the handpiece housing. If collet is difficult to remove by hand, insert the shank of a mandrel, grinding stone, bur or other accessory into the collet. Tap side of accessory lightly with wrench until collet is loosened. Remove collet. **Do not tighten chuck nut down on an empty collet!** This may crack or stress the collet, or may cause the collet to stick in the handpiece. **Do not use undersized or oversized shanks in collet.** Always match shank and collet sizes.