

Replacement Parts

Spare parts are available for your Foredom Flexade® if you wish to do your own service. When ordering parts, service or parts lists be sure to include the model number of your Flexade.

Description	Part No.
Standard Sheath	S.86
Neoprene Sheath	S.86-N
Inner Shaft	S.104
Foredom Grease	MS10006
Motor Couplings	
1/4" hole	S.92-14
5/16" hole	S.92-516
3/8" hole	S.92-38
1/2" hole	S.92-12

Service

Factory repairs are done promptly and at reasonable cost. If you wish, you can send your equipment directly to the factory marked "Attention: Service Department". Be sure to give your street address and email address. The equipment should be accompanied by a brief note describing the problem with the equipment. Estimates will be made upon request.

For More Information

For more information on Foredom machines, handpieces or accessories, contact your local dealer. When no local dealer is available, write, call or fax: **The Foredom Electric Co. 16 Stony Hill Road, Bethel, CT 06801 Phone: 203-792-8622, Fax: 203-796-7861.** You can also visit our website at www.foredom.com.

FOREDOM® Handpieces

(burs not included)

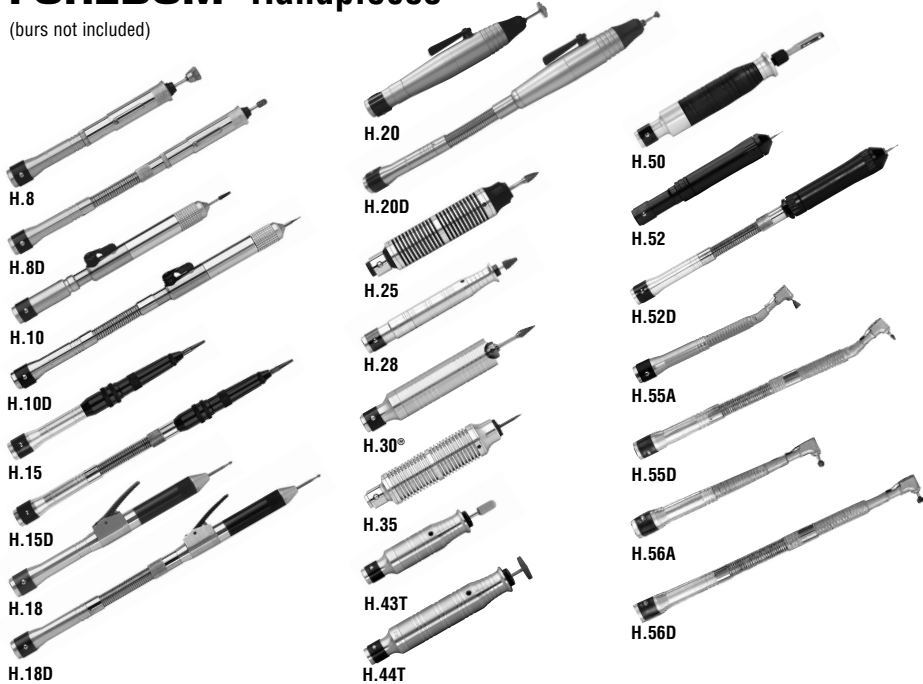

Owner's Manual Assembly, Operation and Service Manual for Flexade®



For Your Own Safety:

- Read this Owner's Manual before operating your Foredom Power Tool.
- Always wear eye protection while using power tools.
- Always use dust collection, respirator, or face mask to prevent inhalation of dust particles from workpiece or abrasives.

FOREDOM®

The Foredom Electric Company, 16 Stony Hill Road, Bethel, CT 06801
www.foredom.com

Form 1293 n 6/08

Printed in U.S.A.

FOREDOM®

www.foredom.com

The Foredom Series B Flexade® is suitable for use with any motor, drill press, or electric drill which operates between **1,500 — 15,000 RPM**. It is ideal for Foredom's BL Bench Lathe which runs at speeds **up to 7,000 rpm**.



The Flexade converts the BL Lathe into a flexible shaft machine. It is shown here with H.44T and H.50 handpieces that are available separately.

The sheath is flexible, tough, long-lasting and impervious to oil and grease.

Handpieces are easy to attach and remove, and can be interchanged with any of Foredom's 20+ quick disconnect (QD) handpieces. The different style handpieces for use with your Flexade are shown on the back of this manual. For more information visit www.foredom.com.

The B Flexade has a 30" shaft with either a standard or more flexible neoprene sheath. It comes equipped with a ball bearing 5/16" coupling for attaching to a 5/16" dia. motor shaft. Other coupling sizes are also available for attaching to 1/4", 3/8", 1/2" dia. motor shafts.

Installation

The Flexade can be attached in a number of ways. When used with a lathe, motor, or any

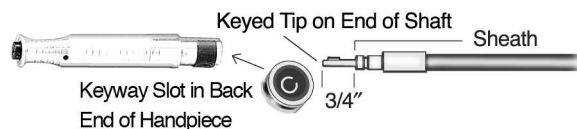

For best performance, the speed should be **3,500 RPM** or more.

Only run the motor or other power source in a forward direction.



The Flexade converts a Drill Press into a flexible shaft machine. It is shown here with an H.8 handpiece that is available separately.

other rotating shaft, simply attach the coupling to the shaft. Be sure to tighten the set screw firmly. Check the rotation. Your Flexade should run counterclockwise.

To install your Flexade in a drill press or electric drill, you need to insert a dowel pin or short piece (2") of round steel into the Flexade coupling. Tighten the set screw after inserting. Then insert the exposed part of the round steel into the drill chuck and close the chuck. Check to be sure that it rotates counterclockwise or in the forward direction. Attach the handpiece by pushing it on the grooved QD fitting on the shaft. Be sure that the keyed tip of the flexible shaft is properly lined up with the keyway slot in the handpiece (see illustration below). If it is not in line, turn the shaft or handpiece to the correct position.

Operation

Your Flexade can be used for any small job of grinding, cutting, polishing, deburring, drilling, etc. Handpieces and accessories for all types of grinding, deburring, polishing, finishing, cleaning, and other applications are available from your Foredom dealer or at www.foredom.com.

The best results will be obtained with a fairly light touch. Heavy pressure will slow down your tool and, if the motor is actually stalled because of heavy pressure or snagging, you may damage the flexible shaft. Let the speed of the tool do the work. Avoid using too much pressure. Generally, slower speeds are used for rougher, heavier work or when greater control over the accessory is required for precise, delicate work.

Voltage Decreases

Never operate a power tool during a perceptible power decrease. Turn off tool and unplug until full power is restored.

Always wear proper eye and face protection when operating a Foredom power tool.

Do Not Do This!



Do not bend shaft and sheath at tight angle

Shafts and sheaths last longer when they are used without sharp bends. If used at angles or loops, wear will occur at the points of greatest friction. When operating your power tools **be careful not to bend the flexible shaft too much at either the handpiece or motor shaft connections.** Excessive heat and wear will occur if the bend is too great.

Follow these guidelines for trouble-free use: **a 4" or larger radius**, as shown, should be maintained for flexade shafts.

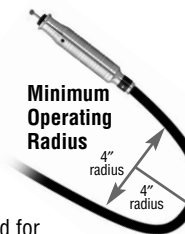

Always turn the flexade power source off and wait until the tool bit or bur comes to a complete stop before you let go of the handpiece.



Flexade Lubrication

The flexible shaft should be lubricated after every 50 hours of operation.



To lubricate the shaft, first take off the handpiece. This is done by giving the handpiece a sharp pull (shown above). Next, loosen the set screw (see illustration at bottom of page) and pull the shaft free of the outer sheath. Apply a VERY light film of Foredom's MS10006 grease along the entire length of the flexible shaft.



IMPORTANT

Replace the sheath, being sure that the flexible shaft tip projects 3/4" beyond the sheath at the handpiece end. When this is correct, tighten set screw. Run the Flexade slowly for several minutes. Turn off the power source, wipe any excess grease from the tip of the flexible shaft and attach the handpiece.

Handpiece Lubrication

Nearly all of Foredom's 20+ different interchangeable handpieces have permanently lubricated ball bearings and **should not be lubricated**. The exceptions are handpieces with duplex spring connections such as the H.8D, H.10D, and H.18D. The spring connections require oiling approximately every 20 hours of use.

Each Foredom handpiece comes with complete instructions for use and maintenance. This can also be downloaded from www.foredom.com.

