

Parts Price List

Series CC, DD, and MM Motors
115 Volt

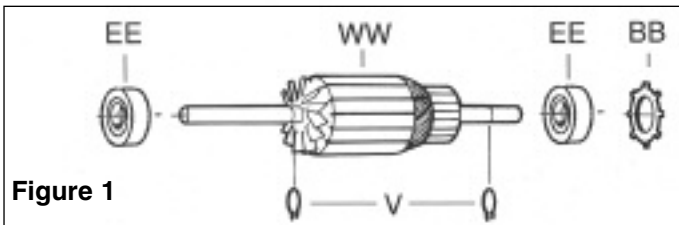
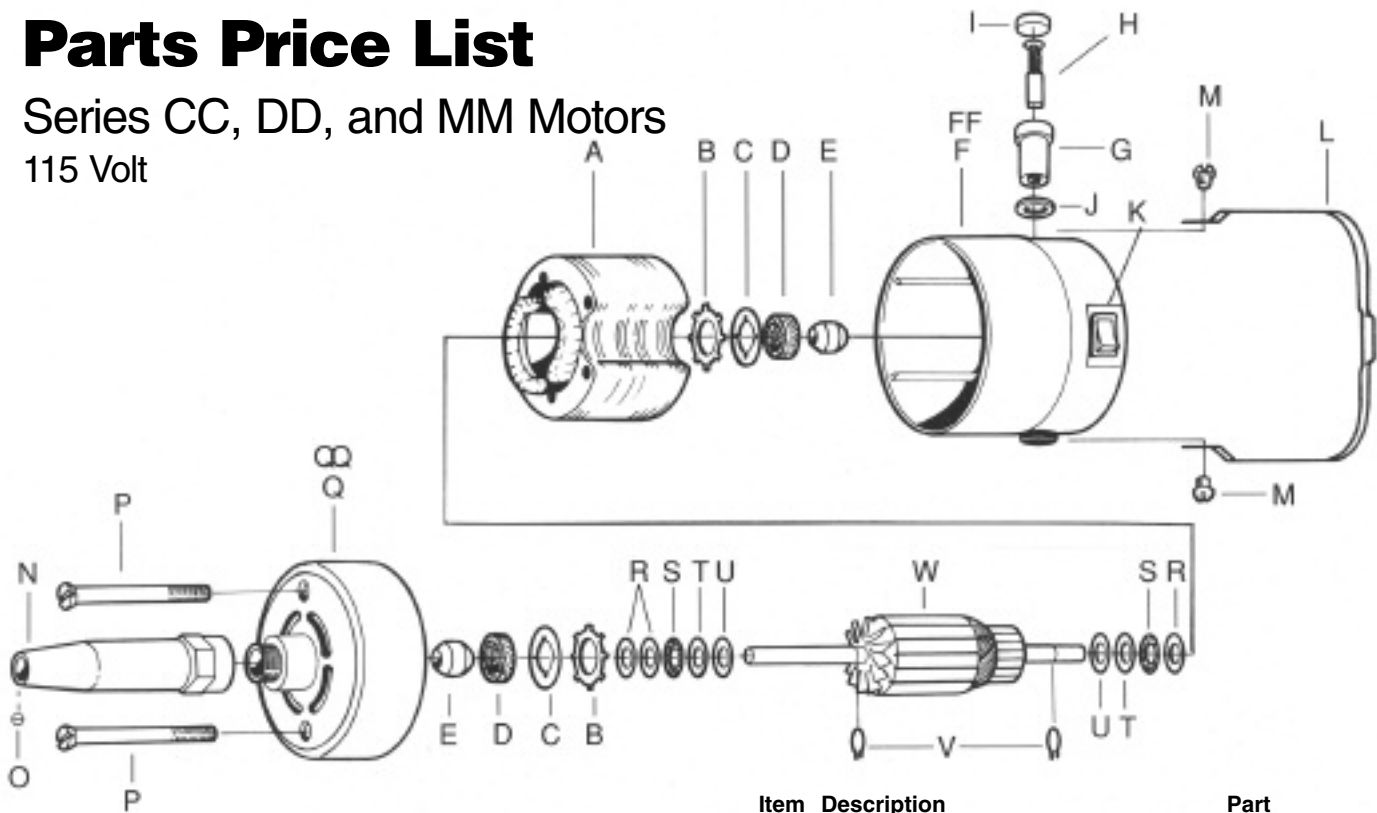

Figure 1

* **Note A:** Ball Bearing Series CC, DD, and MM motors have different armature, bearing assembly and housing parts as illustrated in Figure 1 and listed below. Serial No. B91-1000 and higher are ball bearing motors.

Ball Bearing Motor Parts:

Item	Description	Part No.
FF	Large Housing (N/A)	MP10109B
BB	Spring Washer	MP2018
EE	Ball Bearing (2 Required)	MP186
QQ	Small Housing* (N/A)	MP10282B
V	Snap Ring	MP116
WW	Armature (with 2 Ball Bearings)	MP10283B
Not Shown	Flexible Shaft	S-93
	Sheath (Standard)	S-77
	Neoprene Sheath	S-77N
	Cord (3-wire with Plug)	CP10541
	Cord Grommet	CP10003
	Grease for Flexible Shaft (1 oz. tube)	MS10006
	Oil in hypodermic dispenser for sleeve bearing motors	MS10005
	Utility Hook	UA10113

Item	Description	Part No.
A	Field Coils and Laminators	MP121
B	Spring Retainer	MP187
C	Bearing Retainer	MP10087
D	Felt Oil Wick	MP10084
E	Bearing (2 Required)	MP10249
F	Large Housing*	MP10109
G	Brush Holder	MP118
H	Brush (2 Required)	MP119P
I	Brush Cap	MP120
J	Brush Holder Washer	MP10081
K	On/Off Switch	MP2003
L	Motor Hanger	UA105
M	Motor Hanger Screw (2 Required)	UA106
N	Motor Connector (includes Set Screw)	UA111P
-	Set Screw for Connector	UA113
P	Housing Screw(2 Required)	MP158
Q	Small Housing* (N/A)	MP10282A
R	Armature Washer (thick)	MP115TK
S	Felt Washer (N/A)	MP10083
T	Armature Washer (thin)	MP115TN
U	Brass Washer	MP10513
V	Snap Ring	MP116
W	Armature (with washers & snap rings for sleeve bearing motor)*	MP10283A

*Items F, Q, and W are for sleeve bearing motors only.

FOREDOM®

The Foredom Electric Company, Bethel, CT 06801, USA

Tel.: 203-792-8622 • Fax: 203-796-7861

Email: customerservice@blackstoneind.com www.foredom.net